

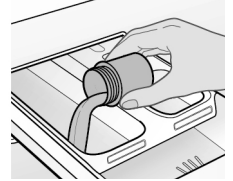

# Compact Washing Machine User Guide

## 1 Add laundry detergent.

Use only high efficiency (HE) liquid laundry detergent in the dispenser drawer. Use the lowest detergent dosage to avoid issues of oversudsing and draining and ensure efficient cleaning of clothes. Do not use scent booster beads as they may clog drain holes in the boot gasket and/or pump of washer.



## 2 Load the machine.

Fill washer halfway with clothes. Items should be loose/not knotted up. Before loading, tie sweatshirt/pants strings together and clean out pockets. Use a mesh laundry bag for smaller items like socks, bibs, and undergarments. Do not load and launder any oversized item as it may not clean properly and/or it may damage the machine.

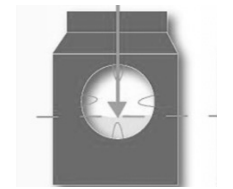

## 3 Select cycle and start the machine.

Choose the appropriate cycle and water temperature for your load.

**Normal:** Normally soiled cottons, linens, sheets, and mixed-garment loads.

**Heavy Duty:** Sturdy, colorfast fabrics and heavily soiled garments.

**Delicates:** Sheer fabrics, undergarments, sweaters, and lightly soiled shirts, blouses, trousers, pants, and skirts.

**Quick Wash:** Small loads of 2-4 lightly soiled garments.

Note, some cycles do not have temperature options due to programming. Press the START button to begin the cycle. Please note that for some models, this button must be held for 3 seconds. The machine will lock and stay locked throughout the cycle.

## 4 Unload the machine.

After removing clothes, leave the washer door open so that excess water can air out. Leaving the door closed can cause mold and mildew to grow. Use washing machine cleaner tablets once a month to help prevent mold and mildew. Wipe down the glass door once a week to prevent debris build up, which can cause leaks by preventing the door from sealing properly.

### Laundry Tips & Best Practices

- If the machine is turning on, but you are unable to start a cycle or select options (with error code Keys Locked/Key Icon/Padlock Icon lit), press and hold the OPTIONS or SOIL and TEMP key(s) for 3 seconds. This will lock or unlock the control for inputs.
- If water is leaking from the front door, clean the glass door to make sure the seal is not being obstructed.

# Automatic

LEASING  SERVICE

CALL 800.558.2342 VISIT [automaticleasing.com](http://automaticleasing.com)



# Compact Dryer User Guide

## 1 Clean the lint screen, bottom filter, and water tank.

Open the dryer door and pull the lint screen out from inside the front panel. (A) Remove the lint and return the lint screen, ensuring the orientation is correct. (B)

If your model is equipped with a water condensation tank and a bottom filter, clean both every time the machine is used. Pull the water condensation tank out and empty the water into the sink. (C) Clean the bottom filter with the control set to ON so that the machine registers that it has been cleaned. (D)

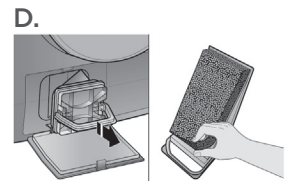
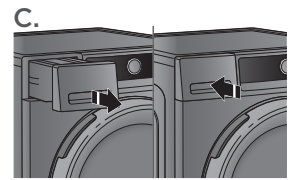
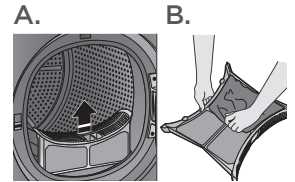

## 2 Load the dryer.

Place clothes loosely inside the machine, add a fabric softener sheet on top of the clothes if desired, and close the door. Do not over pack the dryer as this can cause extended dry times and scorching of some materials due to reduced airflow.

## 3 Select cycle and start the dryer.

Choose the appropriate cycle for your load and press the START button.

**Heavy Duty:** Heavyweight items or heavy work clothes.

**Normal:** Work clothes, mixed cottons, and corduroys.

**Delicates:** Undergarments, blouses, and performance wear.

### Laundry Tips & Best Practices

- Clean the condenser filter weekly with running water. Allow it to dry before reinstalling.
- If equipped, make sure the water tank and bottom filter are both fully closed as this can cause an error and the machine will not be able to operate.
- If the dryer is heating but not drying correctly, please make sure that the lint screen is cleared, as a full lint screen can cause longer dry times and damage the dryer.
- If the machine is turning on, but you are unable to start a cycle or select options (with error code Keys Locked/Key Icon/Padlock Icon lit), press and hold the OPTIONS or SOIL and TEMP key(s) for 3 seconds. This will lock or unlock the control for inputs.
- If the door is not closing, make sure the lint screen is oriented correctly and pushed all the way down. If not, it will prevent the door from closing and the dryer from operating.
- Please note, heat pump dryers operate on lower temperatures to save energy, and therefore usually take 3-4 cycles to dry a load. The warmer it is in the apartment or house, the faster they will dry as they pull air from the room to heat the load.

# Automatic

LEASING  SERVICE

CALL 800.558.2342 VISIT [automaticleasing.com](https://www.automaticleasing.com)